

# Bertram 28 Flybridge Cruiser

1971-94

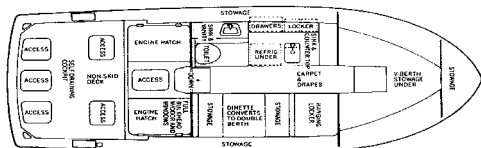

Original Floorplan, 1971-83

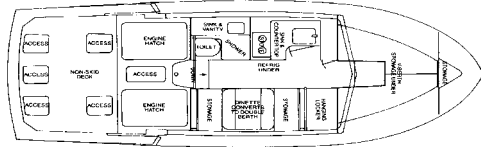

28 II Floorplan, 1983-89

With over 2,800 built, the 28 Flybridge Cruiser remains the best-selling Bertram ever. Designed along the lines of the classic Bertram 31, the 28 quickly established her reputation among serious anglers as a rugged and durable offshore fisherman with comfortable cabin accommodations. She rides on a solid fiberglass deep-V hull, and her 11-foot beam is wide for a 28-footer. Belowdecks, the cabin layout includes berths for four with a convertible dinette, an efficient galley, standup head, and plenty of storage. (The original mica interior was dropped in 1983 and replaced with light oak woodwork.) In 1982 the 28 II came out with a slightly extended cabin bulkhead, in 1994 the fuel was increased to 240 gallons, and with the 28 III model (1990-94) the cabin was slightly revised and the flybridge bench seat was replaced with a pedestal helm seat. Superior workmanship and constant refinements kept the Bertram 28 in the forefront of small fishing boat designs during her long production run. Twin 230hp gas inboards (19 knots cruise/27 knots top) were standard until 1985, when they were replaced with larger 260hp MerCruisers (21 cruise/30 top). In 1992, Volvo 230hp diesels (25 knots cruise) became available.

[www.powerboatguide.com](http://www.powerboatguide.com)

Length.....	28'6"	Fuel .....	185/240 gals.
Beam.....	11'0"	Water .....	54 gals.
Draft.....	2'8"	Waste.....	40 gals.
Weight.....	12,060#	Hull Type .....	Deep-V
Clearance .....	9'4"	Deadrise Aft .....	23°